



**Wiking Museum  
Haithabu**

Landesmuseen SH

Discovery Sheet II

# Discoveries

in the open area and at the houses

 Welterbe  
Haithabu-Danewerk

## INFORMATION ON THE DISCOVERY SHEET II

The Discovery Sheet II is intended to support the children in their independent exploration of the open area and at the Viking houses.

<b>Target group</b>	The sheet aims at school classes from the 3 <sup>rd</sup> grade but also at individual visitors from the age of 8 years and families.
<b>Duration</b>	The processing of the sheet takes about 90 minutes.
<b>Content</b>	<ul style="list-style-type: none"> <li>· Introduction to the topic of Vikings</li> <li>· Tasks to explore the historic site</li> <li>· Tasks to explore the Viking houses</li> </ul>
<b>Materials</b>	<p>The following materials should be kept ready:</p> <ul style="list-style-type: none"> <li>· Pens</li> <li>· Solid writing pad (block or similar)</li> </ul>
<b>Remarks</b>	<ul style="list-style-type: none"> <li>· The processing of the sheet takes place outdoors. Please remember to wear appropriate clothing.</li> <li>· The distance from the parking area to the Viking houses is about 1200 m.</li> <li>· The sheets can be processed individually or in small groups.</li> </ul>
<b>Organizational matters</b>	<ul style="list-style-type: none"> <li>· The leaflet „Viking Houses in Hedeby“ can be used as support. It is available at the ticket office at the Viking houses.</li> <li>· Solution sheets can be downloaded from <a href="http://www.haithabu.de">www.haithabu.de</a>.</li> </ul>



**Wikingermuseum  
Haithabu**

Landesmuseen SH

Discovery Sheet II

# Discoveries

in the open area and at the houses

 **Welterbe  
Haithabu-Danewerk**

## WHO WERE THE VIKINGS?

**1. Hedeby is located between the North Sea and the Baltic Sea at the Schlei. Where exactly?**

Write the correct letters in the boxes number 5 and 6 on the right!



**2. At what period did the Vikings live?**

Write the correct letters in the boxes number 3 and 4 on the right!

Early Middle Ages	<b>EV</b>
Stone Age	<b>SL</b>
Industrial Age	<b>BO</b>

**3. The Vikings are known for being pirates. But what else?**

Write the correct letters in the boxes number 1 and 2 on the right.

Famous scientists	<b>PS</b>
Skilful craftsmen and merchants	<b>AN</b>
Passionate dancers	<b>US</b>

**D**

1

2

3

4

5

6

**K**

**E**

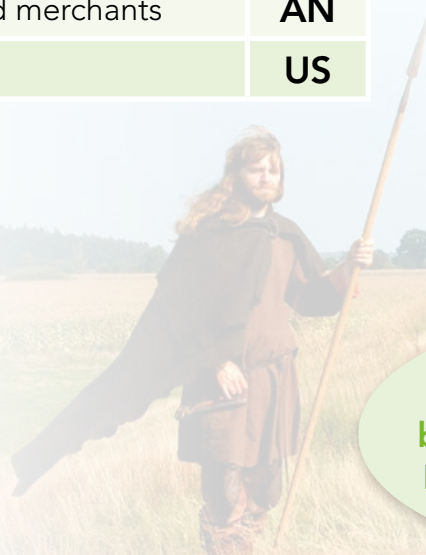

... is the name of the border fortification of the Danish king near Hedeby



**Wikingermuseum  
Haithabu**

Landesmuseen SH

Discovery Sheet II

# Discoveries

in the open area and at the houses

 **Welterbe  
Haithabu-Danewerk**

## ON THE WAY TO THE HOUSES

### 4. Look for this sign!

On the semi-circular ramparts, which protected Hedeby from attacks in the past, descendants of sheep from the Viking Age are still grazing until today.

### What is the name of this breed of sheep?

Skald	<b>P</b>
Skudde	<b>R</b>
Schnucke	<b>U</b>

Write the correct letter  
in box number 3!



### 5. Now look for the information board on the ramparts!

Read the text and find out which of the following did NOT exist in Hedeby!

Workshops	<b>LP</b>
Pit-houses	<b>DÜ</b>
Burial grounds	<b>PI</b>
Castles	<b>TE</b>
Streets and paths	<b>WE</b>
Jetties	<b>KL</b>

Write the correct letters in  
the boxes 4 & 5!

### 6. Keep going until you get to this place!

The sign provides information about the world heritage.

At what year were Hedeby and the Danevirke named world heritage sites?

1995	<b>NU</b>
2000	<b>NE</b>
2018	<b>NO</b>
2019	<b>NA</b>

Write the correct letters  
in the boxes 1 & 2 on the  
right!

 1

 2

 3

 TH

 GA

 4

 5

... is how you call the  
passage in the ramparts  
through which you now  
enter Hedeby."



**Wikingermuseum  
Haithabu**

Landesmuseen SH

Discovery Sheet II

# Discoveries

in the open area and at the houses

**Welterbe  
Haithabu-Danewerk**

## THE HOUSES OF THE VIKINGS I

### 7. Who lived in which house in Hedeby?

Explore the houses and write the correct house number 1–7 on the map! You can identify the houses by their specific items.



Nr.	Description	Items/Feature	Letters
1	Comb maker	Antlers in the workshop	<b>DO</b>
2	Cloth merchant	Weaving loom	<b>HU</b>
3	Merchant	Hides and pottery	<b>ME</b>
4	Wood crafter	Tools, triangular window	<b>OD</b>
5	Hall	Tables and benches	<b>BT</b>
6	Shoemaker	Leather and shoes	<b>AY</b>
7	The Inn	Clay-dome oven	<b>DM</b>

#### 7a: Which house number does the smallest house have?

Write the correct letters in the boxes 7 & 8!

#### 7b: Which house number does the house near the creek have?

Write the correct letters in the boxes 3 & 4!





### 8. Look for the house with this interior wall.

The clay walls are made out of a wattle of ...

Metal	<b>BV</b>
Straw	<b>ST</b>
Twigs	<b>WO</b>

Write the correct letters in the boxes 1 & 2!



and

### 9. The residents of Hedeby didn't know water pipes!

Look for the well and investigate what it is made of! It is ...



... a steel container	<b>ME</b>
... a wooden barrel	<b>CL</b>
... a ton made of plastic	<b>OW</b>

Write the correct letters in the boxes 5 & 6!



...were the most important building materials of the residents of Hedeby.





**Wikingermuseum  
Haithabu**

Landesmuseen SH

Discovery Sheet II

**Discoveries**

in the open area and at the houses

**Welterbe  
Haithabu-Danewerk**

## THE HOUSES OF THE VIKINGS II

### 10. In the house of the cloth merchant

Connect the words with the matching places in the layout plan! But look out! There's one room, which didn't exist in the Viking Age that found its way among the others.

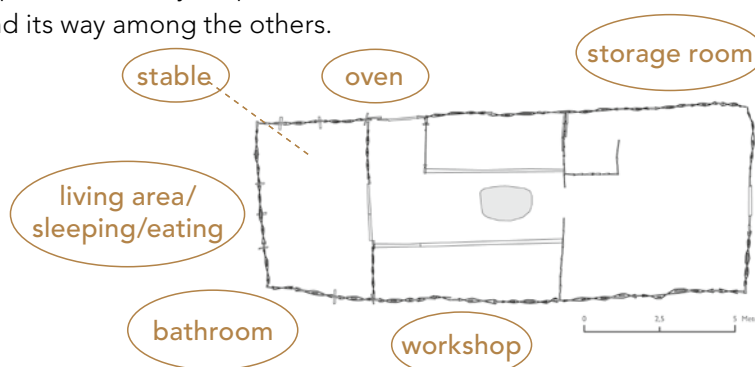

### Which room did not exist back then?

Write the name down! Transfer the first letter in box number 1 on the right!

1						O	M
---	--	--	--	--	--	---	---

1
---

2
---

3
---

4
---

5
---

6
---

7
---

8
---

9
---

S 10
---------

### 11. Explore the materials that were used to build the houses! What was the greatest danger?

Earthquakes	A
Tornados	S
Fire	W

Write the correct letter in box number 6!

... are the names of the wooden »streets« between the houses.

### 12. RIGHT or WRONG?

Highlight the letters of the correct answer and then transfer them in the matching boxes on the right.

Viking houses had...	Right ✓	Wrong ✗	Write the correct letter in box number...
A cellar	D	S	10
A chimney	R	A	7
An hearth	L	V	8
Lockable exterior doors	O	W	2
Sometimes a clay-dome oven	D	K	5
Electric light	H	R	4
Windows with glass panes	E	A	3
Stables and workshops	K	R	9



**Wikingermuseum  
Haithabu**

Landesmuseen SH

Discovery Sheet II

# Discoveries

in the open area and at the houses

**Welterbe  
Haithabu-Danewerk**

## EVERYDAY LIFE OF THE VIKINGS I

**13. This item is placed in the workshop of the cloth merchant.  
What is it?**



Drying rack for fishing nets	PO
Weaving loom	OM
Embroidery frame	UT

Write the correct letters in the boxes 2 & 3  
on the right!

**14. The clothes of the Vikings  
were mainly made out of...**

Write the correct letter in the box number 1!

Wool	C
Silk	K
Rubber	B

**15. Search for this house and take a look at the  
workshop! With which two raw materials does this  
craftsman work?**



Write the correct letters in the  
boxes 4, 6, 7 & 8!

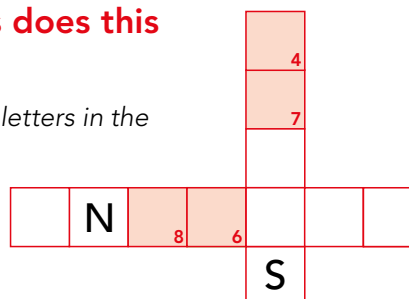

**16. What was made from these raw materials?**

Write the correct letter in box number 9!

Combs, gaming pieces and needles	H
Roofing tiles and toothbrushes	K
Weapons and can opener	B

**Important craftsmen  
in the Viking Age**

**17. Now go to the posterior room of the house! Next to the oven there is  
an object made of two stone disks. What was it used for?**



for grinding grain	C
for frying meat	W
for forging iron	L

Write the correct letter  
in box number 5!

1	
2	5
3	6
4	7
M	8
A	9
K	M
E	E
R	R
C	
H	
A	
N	
T	



**Wiking Museum  
Haithabu**  
Landesmuseen SH

### Discovery Sheet II

# Discoveries

in the open area and at the houses



## EVERYDAY LIFE OF THE VIKINGS II

### 18. Go to the jetty in the former harbour!

Here, long, narrow warships crowded alongside pot-bellied merchant ships that brought goods from distant lands to Hedeby. But there were also smaller boats, like logboats, which were used for fishing.

Below, two ships have snuck in that the Vikings didn't know about yet! Cross them out!

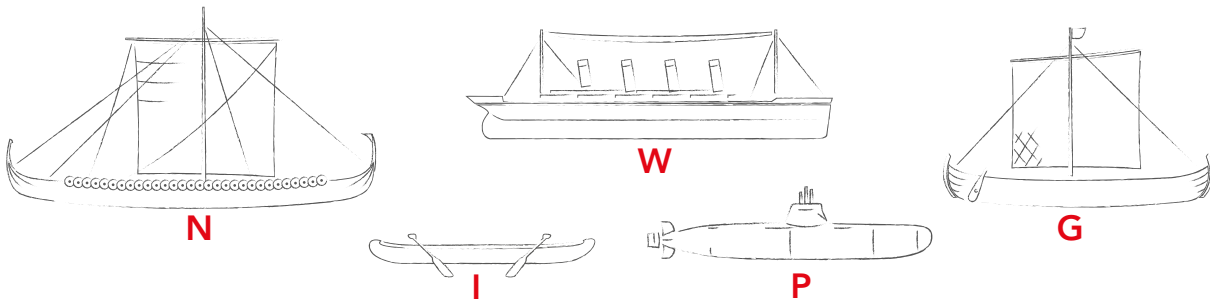

### 19. Which ship is ...

... the warship	Write the letter in box 6
... the merchant ship	Write the letter in box 7
... the logboat	Write the letter in box 5

### 20. The ships brought many goods to Hedeby. In the table there are 6 trade goods hidden! Can you find them?

C	L	A	Y	G	J	U	G	S
O	M	T	J	V	K	W	A	L
M	U	P	F	U	R	S	Z	A
P	Q	R	S	T	C	G	U	V
U	H	Q	J	Y	D	F	S	E
T	C	W	E	A	P	O	N	S
E	B	M	W	I	N	E	Q	P
R	H	K	A	N	G	F	X	R

One of them was not brought to Hedeby. Which one?

C		M					3
---	--	---	--	--	--	--	---

Write the correct letter in box 3 but also in box 4!

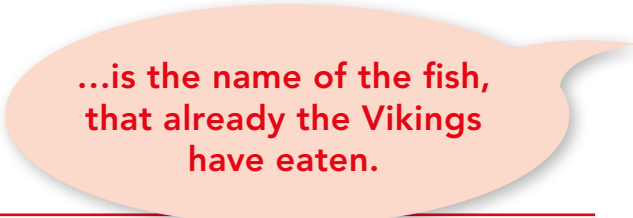

...is the name of the fish, that already the Vikings have eaten.

### 21. Look for the smallest house. Who works here?



Smith	<b>OT</b>
Shoemaker	<b>HE</b>
Fur dealer	<b>LU</b>

Write the letters in the boxes 1 & 2!

1

2

3

4

5

6

7



**Wiking Museum  
Haithabu**

Landesmuseum SH

Discovery Sheet II

**Discoveries**

in the open area and at the houses

 **Welterbe  
Haithabu-Danewerk**

## ADDITIONAL TASK FOR FAST RESEARCHERS!

### Runes - the mysterious characters of the Vikings

Here you can see a translation into today's letters. Try to write down your name in runes.

ƒ u t h a r k    h n i a s    t b m l R

Hint: Maybe you have already noticed that not all letters of our current alphabet are represented.

For the missing ones you have to use similar sounding letters!

For example: a=e, t=d, i=j, b=p, k=g, u=o etc.

Can you decipher this word?

\*†|†:BN



Have you discovered the rune stone?

On the stone it is inscribed:

»Asfrid, the daughter of Odinkar, made these monuments to King Sigtrygg, her and Gnuba's son. Gorm carved the runes.«

The little Sigtrygg stone