



**Wikingermuseum  
Haithabu**

Landesmuseen SH

Discovery Sheet II

# Discoveries

in the open area and at the houses

 **Welterbe  
Haithabu-Danewerk**

## WHO WERE THE VIKINGS?

## Solution sheet

**1. Hedeby is located between the North Sea and the Baltic Sea at the Schlei. Where exactly?**

Write the correct letters in the boxes number 5 and 6 on the right!



**2. At what period did the Vikings live?**

Write the correct letters in the boxes number 3 and 4 on the right!

Early Middle Ages	<b>EV</b>
Stone Age	<b>SL</b>
Industrial Age	<b>BO</b>

**3. The Vikings are known for being pirates. But what else?**

Write the correct letters in the boxes number 1 and 2 on the right.

Famous scientists	<b>PS</b>
Skilful craftsmen and merchants	<b>AN</b>
Passionate dancers	<b>US</b>

**D**

**A**<sub>1</sub>

**N**<sub>2</sub>

**E**<sub>3</sub>

**V**<sub>4</sub>

**I**<sub>5</sub>

**R**<sub>6</sub>

**K**

**E**



... is the name of the border fortification of the Danish king near Hedeby



**Wikingermuseum  
Haithabu**

Landesmuseen SH

Discovery Sheet II

# Discoveries

in the open area and at the houses

 **Welterbe  
Haithabu-Danewerk**

## ON THE WAY TO THE HOUSES

## Solution sheet

### 4. Look for this sign!

On the semi-circular ramparts, which protected Hedeby from attacks in the past, descendants of sheep from the Viking Age are still grazing until today.

### What is the name of this breed of sheep?

Skald	P
Skudde	<b>R</b>
Schnucke	U

Write the correct letter  
in box number 3!



### 5. Now look for the information board on the ramparts!

Read the text and find out which of the following did NOT exist in Hedeby!

Workshops	LP
Pit-houses	DÜ
Burial grounds	PI
Castles	<b>TE</b>
Streets and paths	WE
Jetties	KL

Write the correct letters in  
the boxes 4 & 5!

### 6. Keep going until you get to this place!

The sign provides information about the world heritage.

At what year were Hedeby and the Danevirke named world heritage sites?

1995	NU
2000	NE
2018	<b>NO</b>
2019	NA

Write the correct letters  
in the boxes 1 & 2 on the  
right!



... is how you call the  
passage in the ramparts  
through which you now  
enter Hedeby."

N<sub>1</sub>

O<sub>2</sub>

R<sub>3</sub>

TH

GA

T<sub>4</sub>

E<sub>5</sub>



**Wikingermuseum  
Haithabu**

Landesmuseen SH

Discovery Sheet II

# Discoveries

in the open area and at the houses

Welterbe  
Haithabu-Danewerk

## THE HOUSES OF THE VIKINGS I

## Solution sheet

### 7. Who lived in which house in Hedeby?

Explore the houses and write the correct house number 1–7 on the map! You can identify the houses by their specific items.

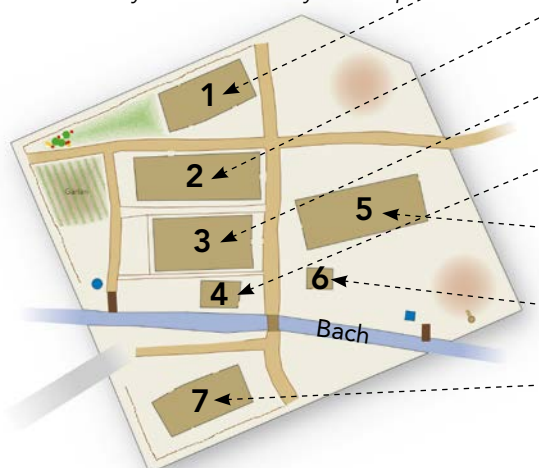

Nr.	Description	Items/Feature	Letters
1	Comb maker	Antlers in the workshop	DO
2	Cloth merchant	Weaving loom	HU
3	Merchant	Hides and pottery	ME
4	Wood crafter	Tools, triangular window	ⓄD
5	Hall	Tables and benches	BT
6	Shoemaker	Leather and shoes	ⓐY
7	The Inn	Clay-dome oven	DM

### 7a: Which house number does the smallest house have?

Write the correct letters in the boxes 7 & 8!

### 7b: Which house number does the house near the creek have?

Write the correct letters in the boxes 3 & 4!

### 8. Look for the house with this interior wall.

The clay walls are made out of a wattle of ...

Metal	BV
Straw	ST
Twigs	Ⓞ

Write the correct letters in the boxes 1 & 2!



### 9. The residents of Hedeby didn't know water pipes!

Look for the well and investigate what it is made of! It is ...



... a steel container	ME
... a wooden barrel	ⓄL
... a ton made of plastic	OW

Write the correct letters in the boxes 5 & 6!

...were the most important building materials of the residents of Hedeby.

W<sub>1</sub>

O<sub>2</sub>

O<sub>3</sub>

D<sub>4</sub>

and

C<sub>5</sub>

L<sub>6</sub>

A<sub>7</sub>

Y<sub>8</sub>





**Wiking Museum  
Haithabu**

Landesmuseen SH

Discovery Sheet II

**Discoveries**

in the open area and at the houses

**Welterbe  
Haithabu-Danewerk**

## THE HOUSES OF THE VIKINGS II

## Solution sheet

### 10. In the house of the cloth merchant

Connect the words with the matching places in the layout plan! But look out! There's one room, which didn't exist in the Viking Age that found its way among the others.

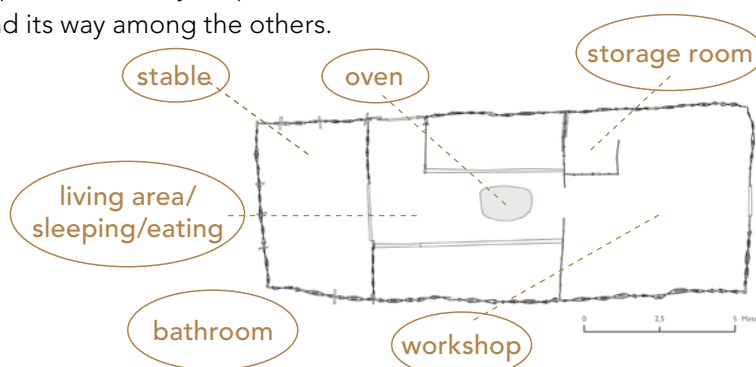

### Which room did not exist back then?

Write the name down! Transfer the first letter in box number 1 on the right!

**B** A T H R O O M

**B**<sub>1</sub>

**O**<sub>2</sub>

**A**<sub>3</sub>

**R**<sub>4</sub>

**D**<sub>5</sub>

**W**<sub>6</sub>

**A**<sub>7</sub>

**L**<sub>8</sub>

**K**<sub>9</sub>

**S**<sub>10</sub>

### 11. Explore the materials that were used to build the houses!

### What was the greatest danger?

Earthquakes	<b>A</b>
Tornados	<b>S</b>
Fire	<b>W</b>

Write the correct letter in box number 6!

... are the names of the wooden »streets« between the houses.

### 12. RIGHT or WRONG?

Highlight the letters of the correct answer and then transfer them in the matching boxes on the right.

Viking houses had...	Right ✓	Wrong ✗	Write the correct letter in box number...
A cellar	D	<b>S</b>	10
A chimney	R	<b>A</b>	7
An hearth	<b>L</b>	V	8
Lockable exterior doors	<b>O</b>	W	2
Sometimes a clay-dome oven	<b>D</b>	K	5
Electric light	H	<b>R</b>	4
Windows with glass panes	E	<b>A</b>	3
Stables and workshops	<b>K</b>	R	9



**Wikingermuseum  
Haithabu**

Landesmuseen SH

Discovery Sheet II

# Discoveries

in the open area and at the houses

Welterbe  
Haithabu-Danewerk

## EVERYDAY LIFE OF THE VIKINGS I

## Solution sheet

13. This item is placed in the workshop of the cloth merchant.  
What is it?



Drying rack for fishing nets	PO
Weaving loom	ⓄM
Embroidery frame	UT

Write the correct letters in the boxes 2 & 3  
on the right!

C<sub>1</sub>

O<sub>2</sub> C<sub>5</sub>

M<sub>3</sub> L<sub>6</sub>

B<sub>4</sub> O<sub>7</sub>

M T<sub>8</sub>

A H<sub>9</sub>

K M

E E

R R

C

H

A

N

T

14. The clothes of the Vikings  
were mainly made out of...

Write the correct letter in the box number 1!

Wool	Ⓒ
Silk	K
Rubber	B

15. Search for this house and take a look at the  
workshop! With which two raw materials does this  
craftsman work?



Write the correct letters in the  
boxes 4, 6, 7 & 8!

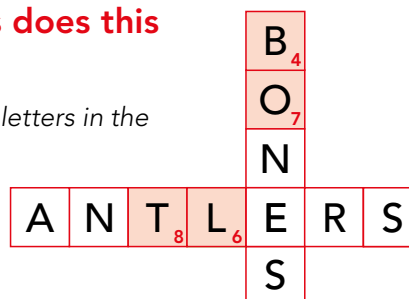

16. What was made from these raw materials?

Write the correct letter in box number 9!

Combs, gaming pieces and needles	Ⓗ
Roofing tiles and toothbrushes	K
Weapons and can opener	B

Important craftsmen  
in the Viking Age

17. Now go to the posterior room of the house! Next to the oven there is  
an object made of two stone disks. What was it used for?



for grinding grain	Ⓒ
for frying meat	W
for forging iron	L

Write the correct letter  
in box number 5!



**Wiking Museum  
Haithabu**

Landesmuseen SH

Discovery Sheet II

**Discoveries**

in the open area and at the houses

**Welterbe  
Haithabu-Danewerk**

## EVERYDAY LIFE OF THE VIKINGS II

## Solution sheet

### 18. Go to the jetty in the former harbour!

Here, long, narrow warships crowded alongside pot-bellied merchant ships that brought goods from distant lands to Hedeby. But there were also smaller boats, like logboats, which were used for fishing.

Below, two ships have snuck in that the Vikings didn't know about yet! Cross them out!

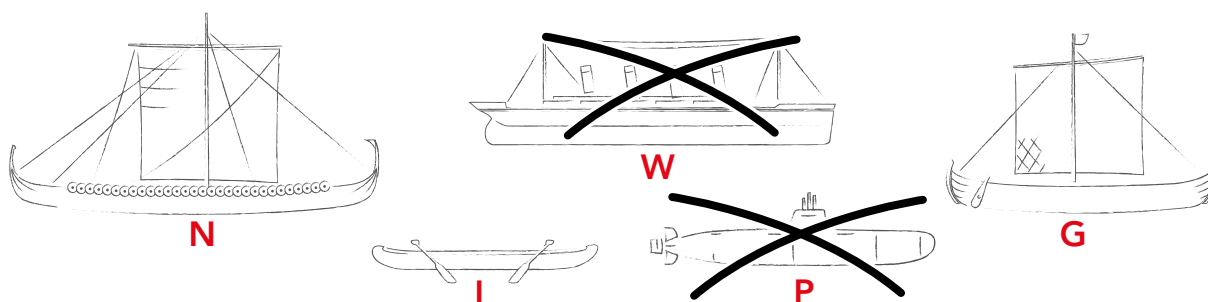

### 19. Which ship is ...

... the warship	Write the letter in box 6
... the merchant ship	Write the letter in box 7
... the logboat	Write the letter in box 5

### 20. The ships brought many goods to Hedeby. In the table there are 6 trade goods hidden! Can you find them?

C	L	A	Y	G	J	U	G	S
O	M	T	J	V	K	W	A	L
M	U	P	F	U	R	S	Z	A
P	Q	R	S	T	C	G	U	V
U	H	Q	J	Y	D	F	S	E
T	C	W	E	A	P	O	N	S
E	B	M	W	I	N	E	Q	P
R	H	K	A	N	G	F	X	R

One of them was not brought to Hedeby. Which one?

C O M P U T E R<sub>3</sub>

Write the correct letter in box 3 but also in box 4!

...is the name of the fish,  
that already the Vikings  
have eaten.

H<sub>1</sub>

E<sub>2</sub>

R<sub>3</sub>

R<sub>4</sub>

I<sub>5</sub>

N<sub>6</sub>

G<sub>7</sub>

### 21. Look for the smallest house. Who works here?



Smith	OT
Shoemaker	HE
Fur dealer	LU

Write the letters in the  
boxes 1 & 2!



**Wiking Museum  
Haithabu**

Landesmuseen SH

Discovery Sheet II

**Discoveries**

in the open area and at the houses

 **Welterbe  
Haithabu-Danewerk**

**ADDITIONAL TASK FOR FAST RESEARCHERS!**

**Solution sheet**

## Runes - the mysterious characters of the Vikings

Here you can see a translation into today's letters. Try to write down your name in runes.

ƒ ũ th a r k    h n i a s    t b m l R

Hint: Maybe you have already noticed that not all letters of our current alphabet are represented.

For the missing ones you have to use similar sounding letters!

For example: a=e, t=d, i=j, b=p, k=g, u=o etc.

Can you decipher this word?

\*†|†:BN **HAITHABU**



Have you discovered the rune stone?

On the stone it is inscribed:

»Asfrid, the daughter of Odinkar, made these monuments to King Sigtrygg, her and Gnuba's son. Gorm carved the runes.«

The little Sigtrygg stone